

SAHABİYE MEDRESESİ

TÖREN ALANI

VALİLİK BİNASI

SAAT KULESİ

ATATÜRK HEYKELİ

KAYSERİ KALESİ

TRAMVAY

BÜRÜNGÜZ CAMİ

KAYSERİ



SQUARE CLASSIFICATION

- Paul Zucker

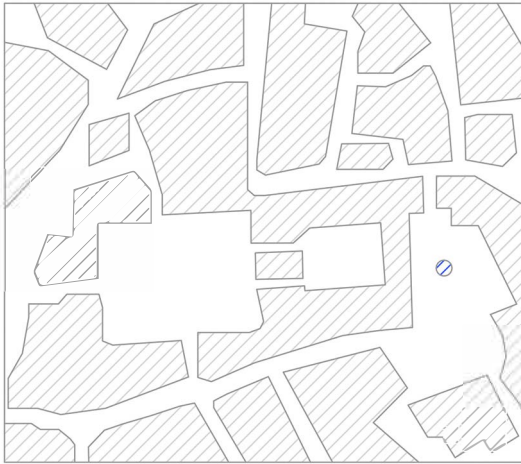

The **Closed** Square

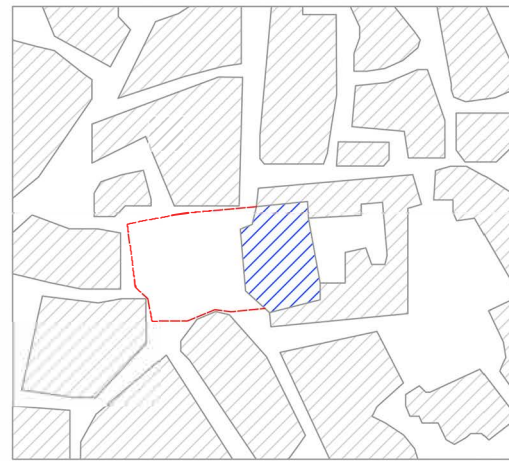

The **Dominated** Square

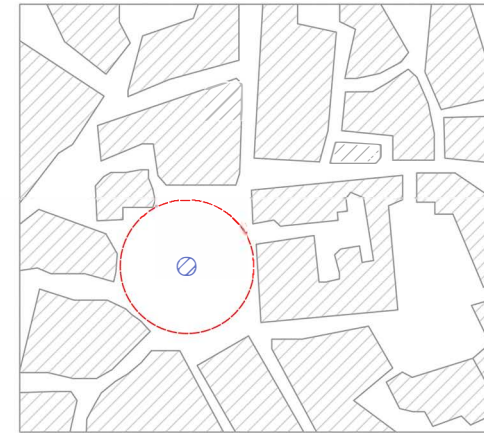

The **Nuclear** Square

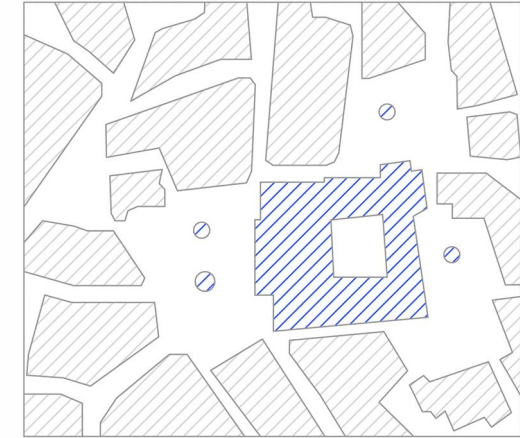

The **Amorphous** Square

Which Class Does **Kayseri Cumhuriyet Meydanı** Fall Into?

AMORPHOUS SQUARE

. LACK OF EDGE CONTINUITY

The demolition of the former **Government Building**, subsequent **road widenings**, and the presence of **open parking areas** have completely disrupted the **continuity** of the square's edges.

. ABSENCE OF A READABLE SPATIAL BOUNDARY

While the citadel on the north side creates a **strong, rigid edge**, the other three sides allow space to "**dissolve**" and **flow outward**. This condition directly corresponds to Zucker's definition of an amorphous square.

. LOSS OF FOCAL POINTS

The **Clock Tower** alone is insufficient to establish **spatial orientation or enclosure**, and the tramway line further **fragments** the potential for a central focus.

. A LARGE BUT UNDEFINED VOID

Cumhuriyet Meydanı functions today as an **expansive surface** with weak spatial character. Its scale is **large**, yet its structure is diffuse and difficult to interpret—precisely Zucker's description of an amorphous public space with **undefined edges and leftover space**.



MACRO SCALE KAYSERİ

İSTASYON STREET

SİVAS STREET

OSMAN KAVUNCU
BOULEVARD

1

2

TALAS STREET

4

Cumhuriyet Meydanı is located at the intersection of three major urban axes in the center of Kayseri:

- . **Talas Road** to the south (running east-west),
- . **Sivas Avenue** to the east,
- . **İstasyon Avenue**, which connects to the northern ring road.

1- Grand Bazaar 2- Inner Castle



CUMHURİYET SQUARE

A- Artifacts from the Roman Period That Have Not Survived

- 1-A: Roman Tomb
- 2-A: Ulu Cami (Built as the Church of **Agios Basileos** during the Eastern Roman Period)

B- Artifacts from the Seljuk Period That Have Not Survived

- 1-B: Seljuk Palace
- 2-B: Melikgazi Madrasa
- 3-B: Hacet Mosque
- 4-B: Pervane Bey Madrasa (Foundation remains remain today.)

C- Artifacts from the Beylik Period That Have Not Survived

- 1-C: Asmalı Fountain (The fountain that exists today was built in the 19th century and was placed on the inscription of the original Asmalı Fountain.)

D- Artifacts from the Ottoman Period That Have Not Survived

- 1-D: The boundaries of the Grand Bazaar
- 2-D: Paşa Hamamı
- 3-D: Asmalı Mosque (The Güngörmez Mosque stands today on its site)
- 4-D: Kocağazade Ahmet Mektebi
- 5-D: Mahkeme Hanı
- 6-D: Houses within the castle (built in the 17th century)

--- Roads from the Wall Gates to the Grand Bazaar

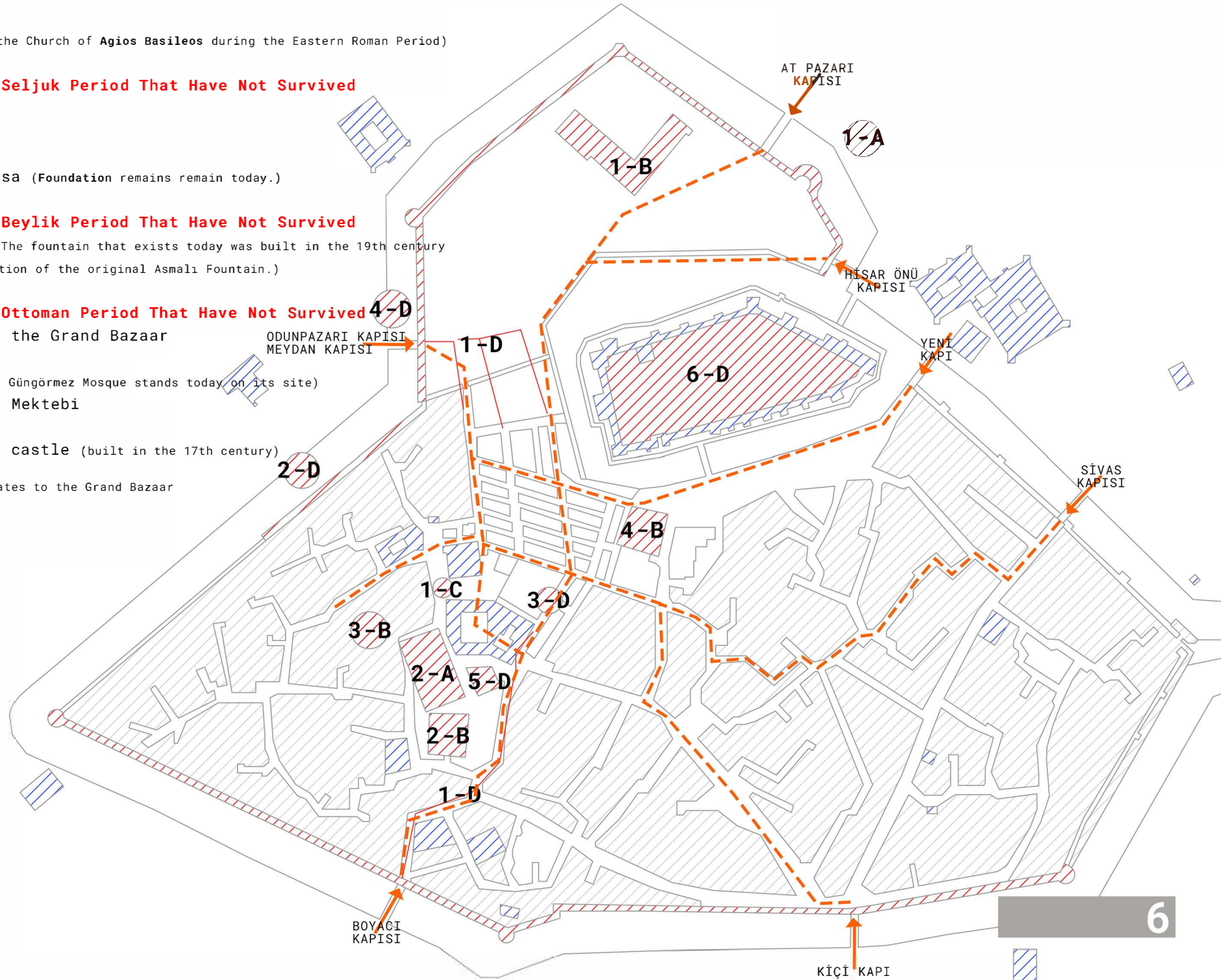



SOLID - VOID



- 1- Grand Bazaar
- 2- Inner Castle
- 3- Bürüngüz Mosque
- 4- Kurşunlu Mosque
- 5- Hotel & AVM
- 6- Sahabiye Madrasa
- 7- Clock Tower & Atatürk Statue
- 8- Governorship Building
- 9- Hunat Mosque and Cultural Complex



HISTORICAL BUILDINGS

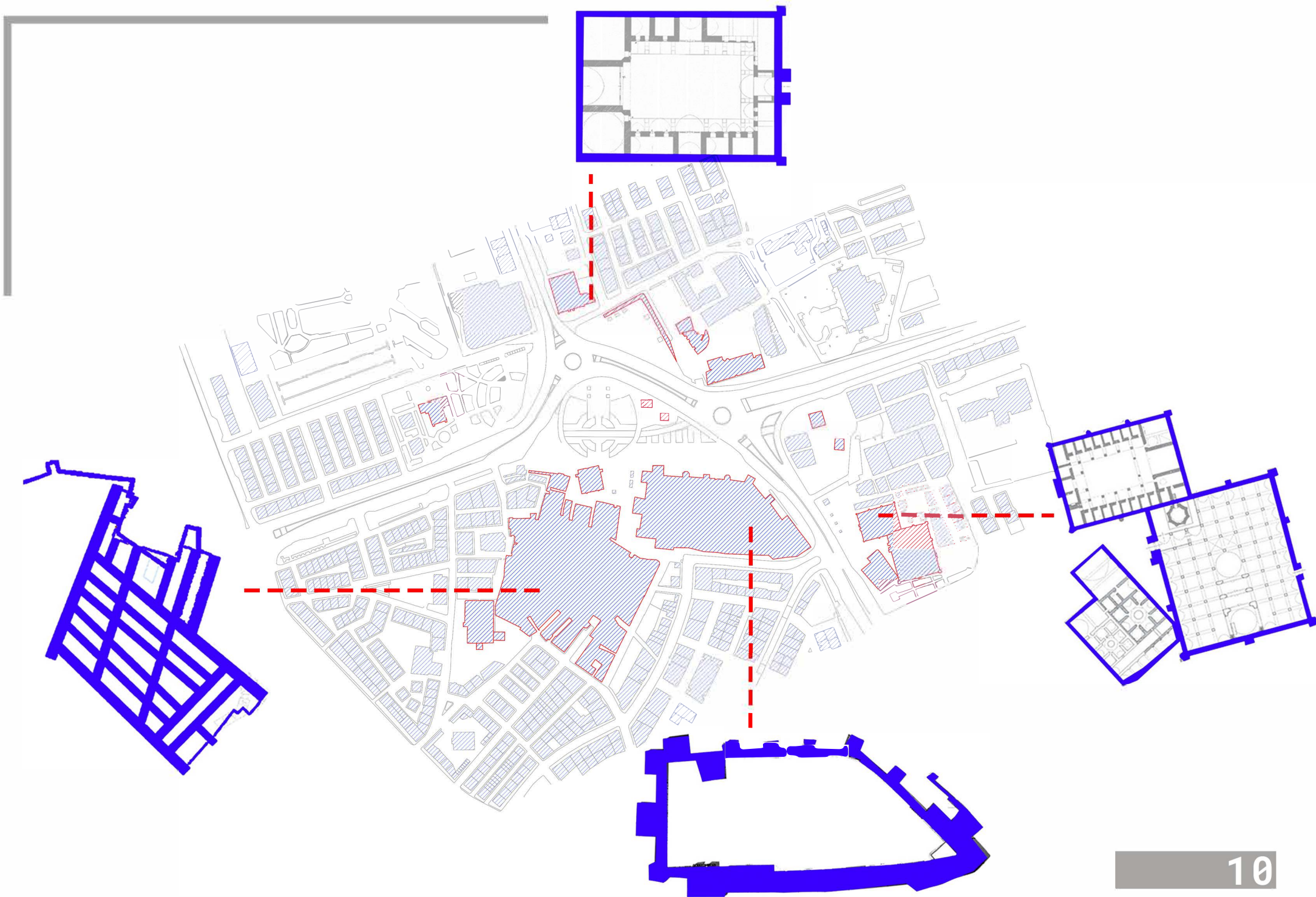



GREEN AREAS





CIRCULATION





LOST SPACE

- Roger Trancik

0) THEORETICAL BACKBONE: How Do We Relate Trancik's "Lost Space" to Kayseri?

Trancik's core argument is that, in the modern city, certain urban voids cease to function as public spaces and instead turn into **residual, unreadable, and context-detached** environments defined as "**lost spaces.**"

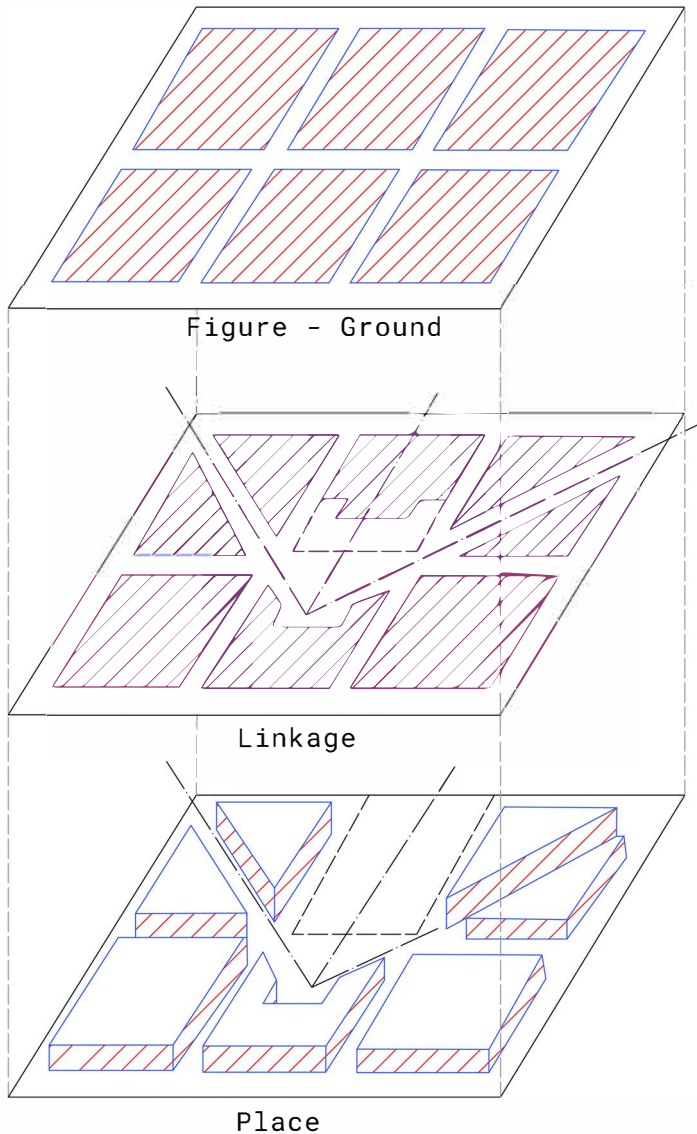

The primary drivers of this transformation are:

- 1- Disruption of historical continuity
- 2- Breakdown of the building-void relationship, leading to a loss of figure-ground legibility
- 3- Fragmentation of space through connectivity decisions (roads, tram lines, vehicular infrastructure), which divide the urban fabric and produce anti-place conditions



SPATIAL LEGIBILITY GRADIENT

- Kevin Lynch

. Spatial Legibility Gradient (SLG)

Spatial legibility within the square varies across different areas according to the distribution of Lynch's urban-image components.

- . In some locations, landmark density is high.
- . In others, the relationship between paths and edges is weak or ambiguous.

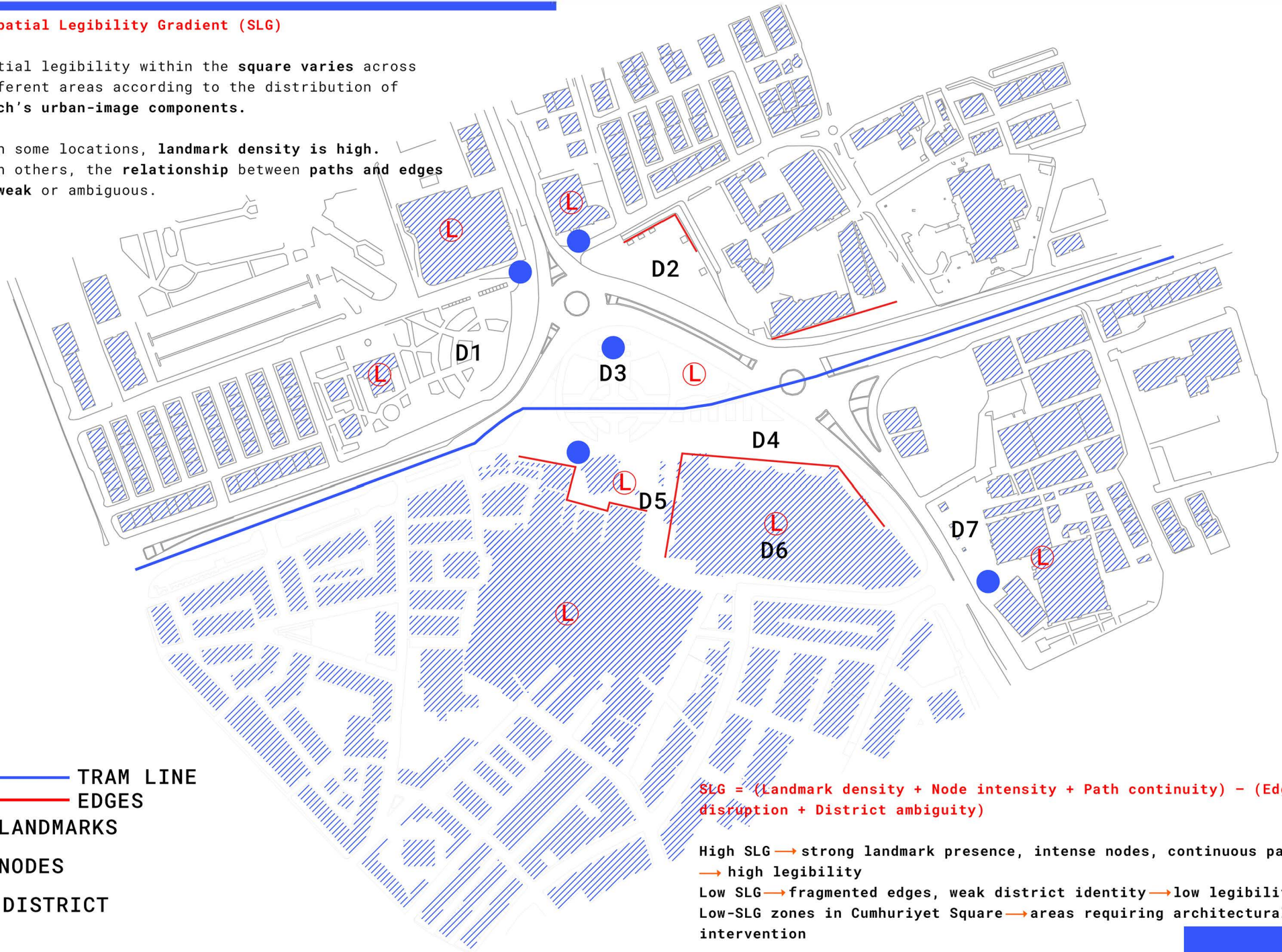



ENCLOSURE

- Roger Trancik
- Camillo Sitte

1) SPATIAL ENCLOSURE RATIO: Does the “urban room” actually work?)

For a space to be **perceived as a spatial “room”** from a given viewpoint:

D = the **horizontal distance** between the observer and the perceived **boundary / façade / wall**

H = the **height** of the **dominant element** forming that boundary

$$\text{SER} = D / H$$

1.1 READING THRESHOLDS:

SER ≤ 2 → strong enclosure (**clear room effect**)

2 < SER ≤ 4 → loose enclosure (**semi-room condition**)

SER > 4 → tendency toward lost space (**spatial dispersion**)

SER < 1 → excessive compression / pressure (**the wall functions as an obstacle rather than a background**)

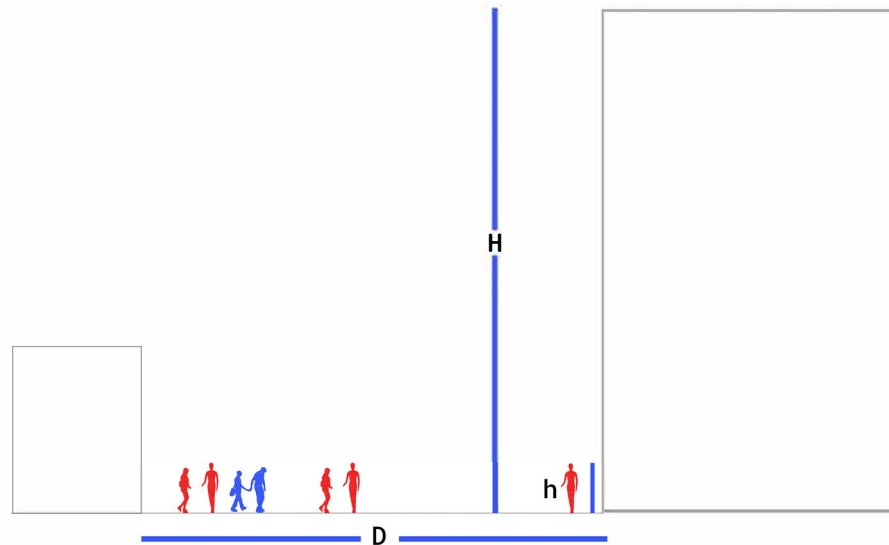







1.2A KAYSERİ CASTLE:

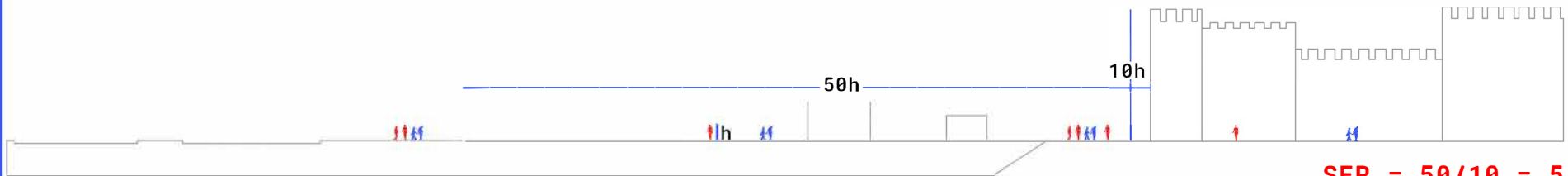

$$\text{SER} = 50/10 = 5$$

$\text{SER} > 4$ tendency toward lost space (spatial dispersion)

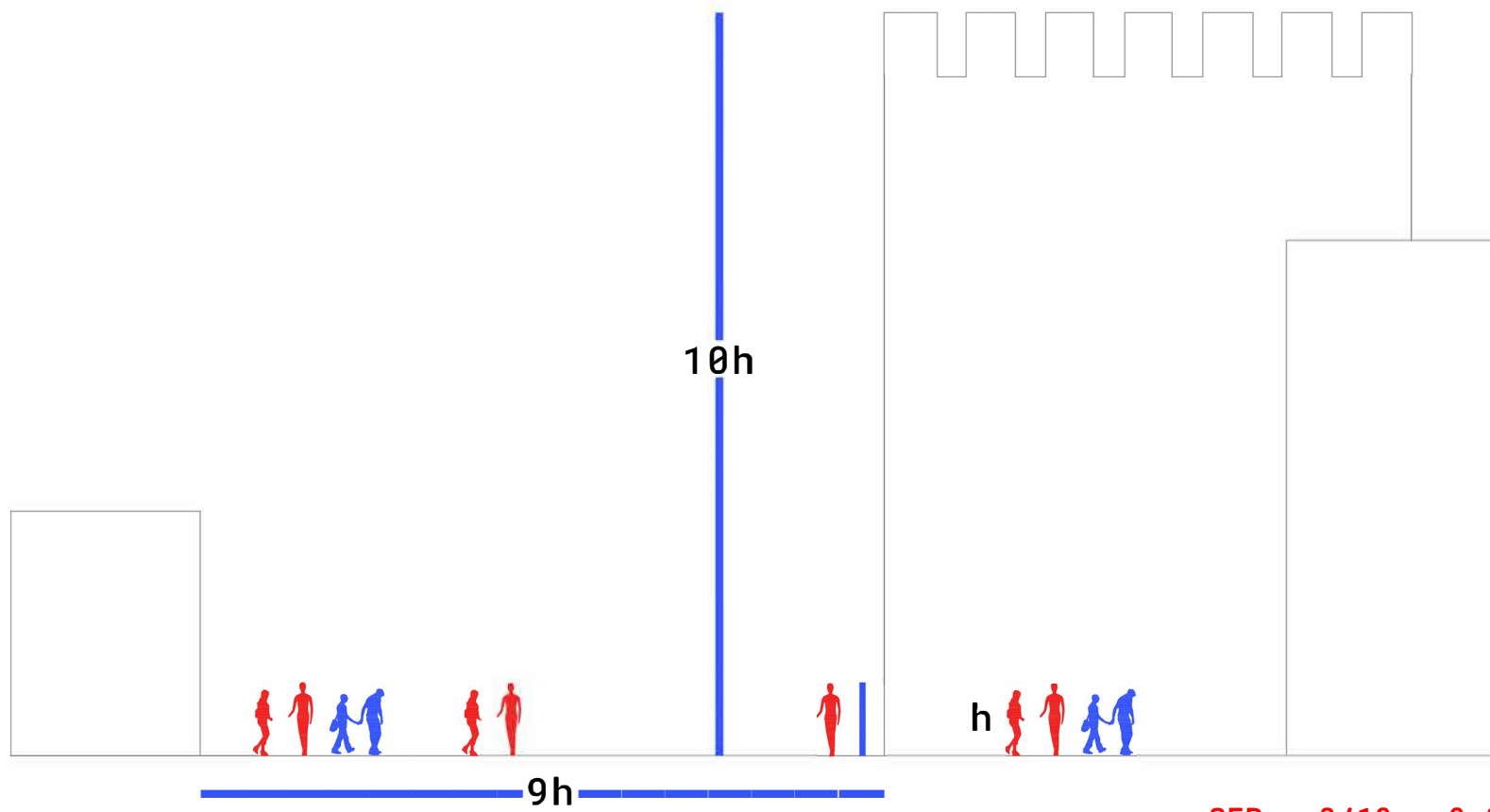

$$\text{SER} = 9/10 = 0,9$$

$\text{SER} < 1$ excessive compression / pressure (the wall functions as an obstacle rather than a background)



TRACE

- Aldo Rossi

2) HISTORICAL TRACE INTENSITY:

Historical Trace Intensity measures the **number of memory-bearing elements** within an urban space.

These elements may include:

Trees that function as **period-specific landmarks**

Ventilation chimneys (such as those related to underground bazaars)

Historically aligned **street traces**

Former building footprints, indicated through changes in **ground material, lighting traces, or curbs**

Lines, niches, or level differences marking former mansion edges or façade boundaries

2.1 READING THRESHOLDS:

HTI \geq 5 \longrightarrow High historical trace intensity

2 \leq HTI $<$ 5 \longrightarrow Medium

HTI $<$ 2 \longrightarrow Low (risk of lost space)

1- Kayseri Tarihi Kalesi, 2- Hunat Hatun Külliyesi, 3- Fevziöglü İş Merkezi, 4- Tekel Binası, 5- PTT Binası, 6- Zeynel Abidin Türbesi, 7- Ok Burcu, 8- Alemdar Sineması ve Oteli, 9- Saat Kulesi, 10- İkinci Hükümet Konağı, 12- Sahip Ata Medresesi, 13- Kurşunlu Cami, 14- İlk Atatürk Heykeli, 15- Kapalı Çarşı, 16- Eski Tören Alanı

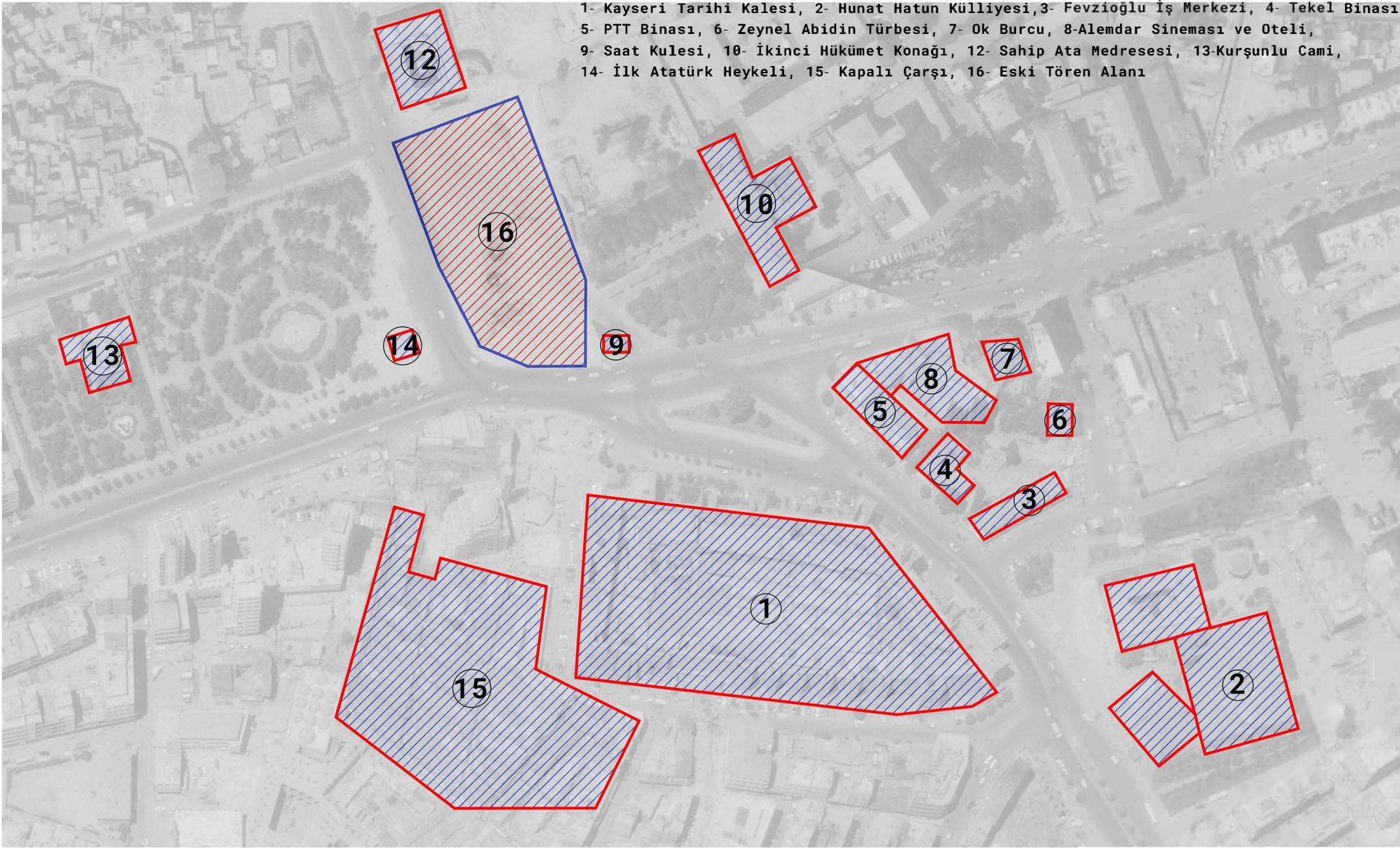

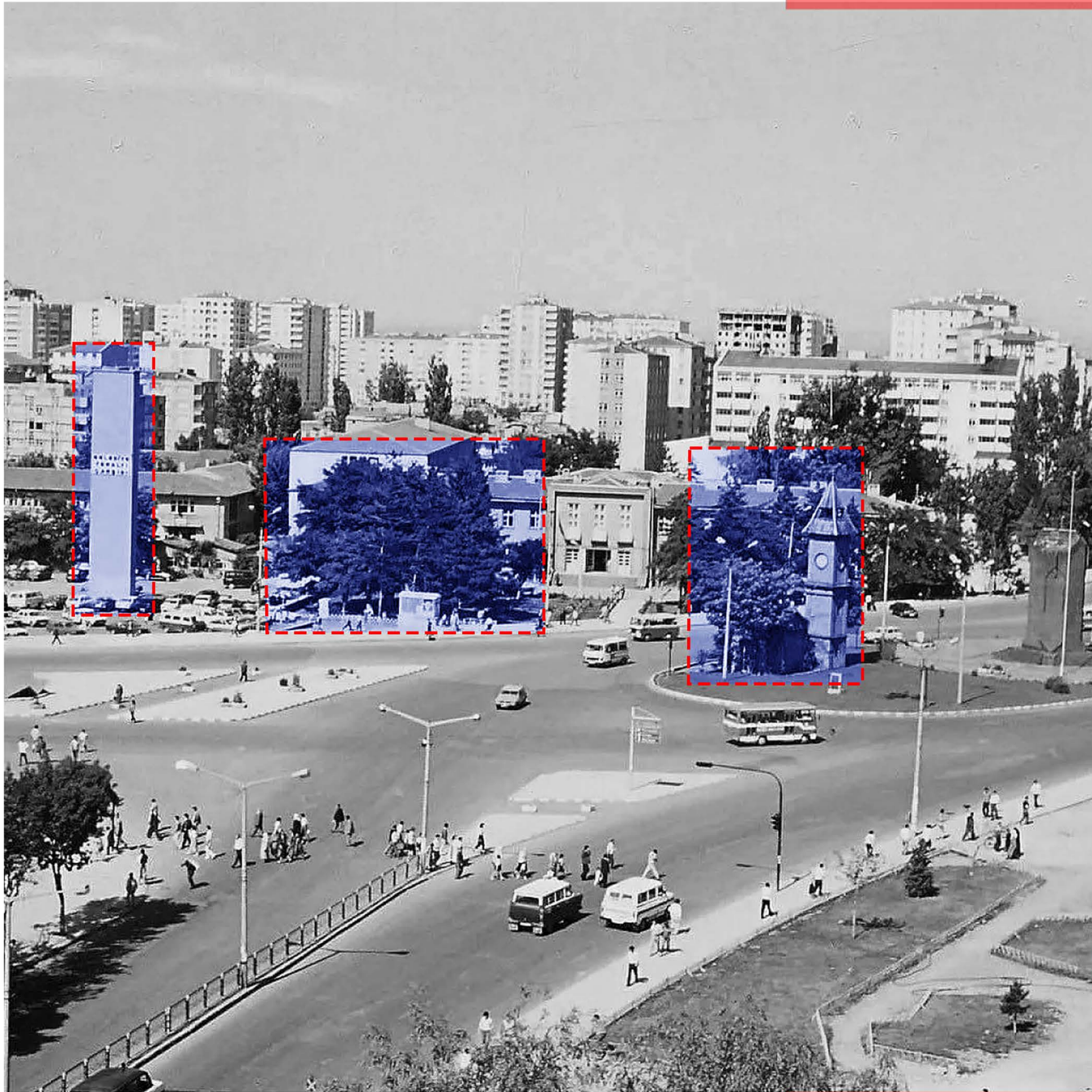





2.2A INNER CASTLE - KAPALIÇARŞI AXIS:

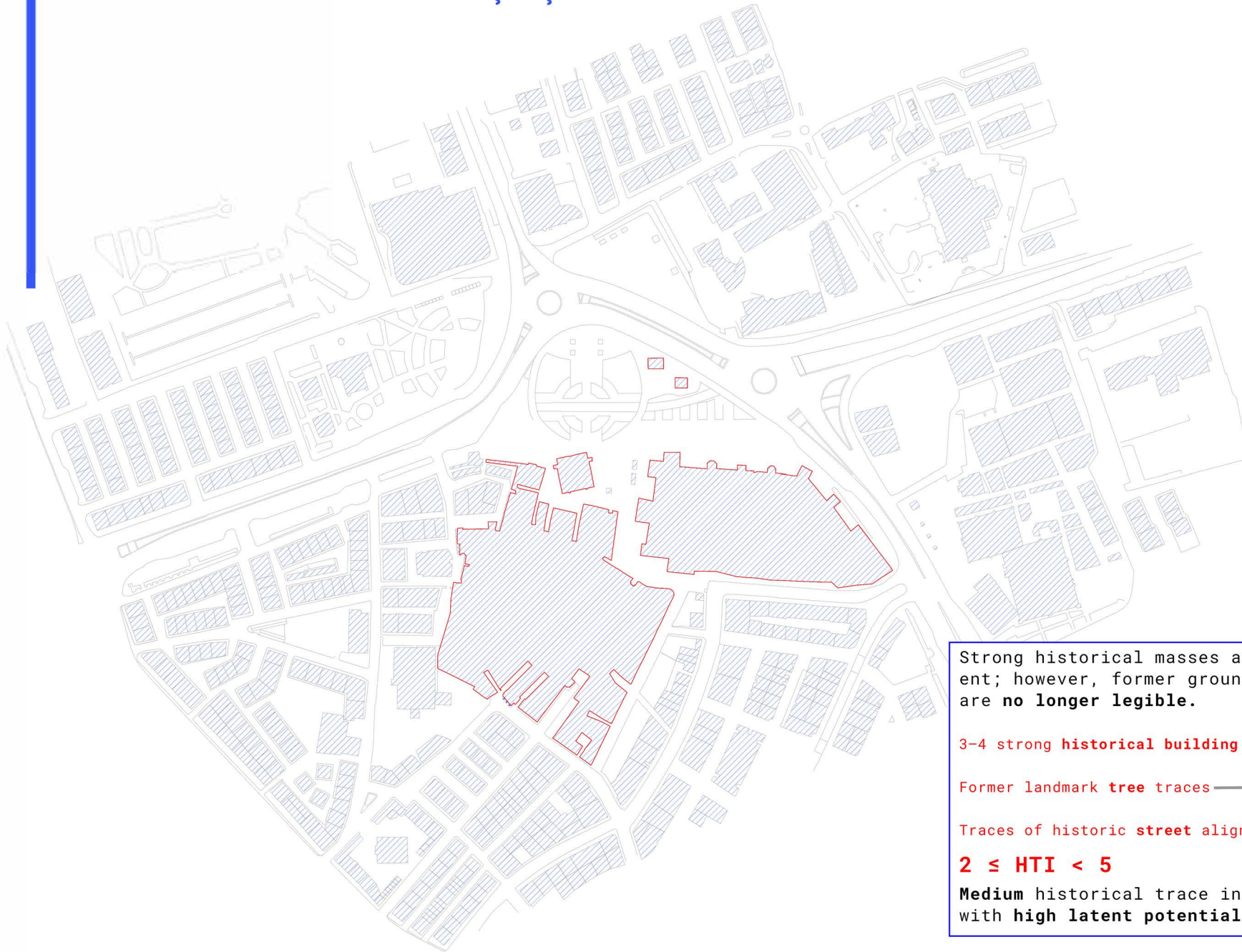

Strong historical masses are still present; however, former ground-level traces are **no longer legible**.

3-4 strong **historical building anchors** → +4

Former landmark **tree traces** → 0

Traces of historic **street alignments** → 0

2 ≤ HTI < 5

Medium historical trace intensity, but with **high latent potential**.

2.2B CEREMONIAL SQUARE – GOVERNOR'S BUILDING AXIS:

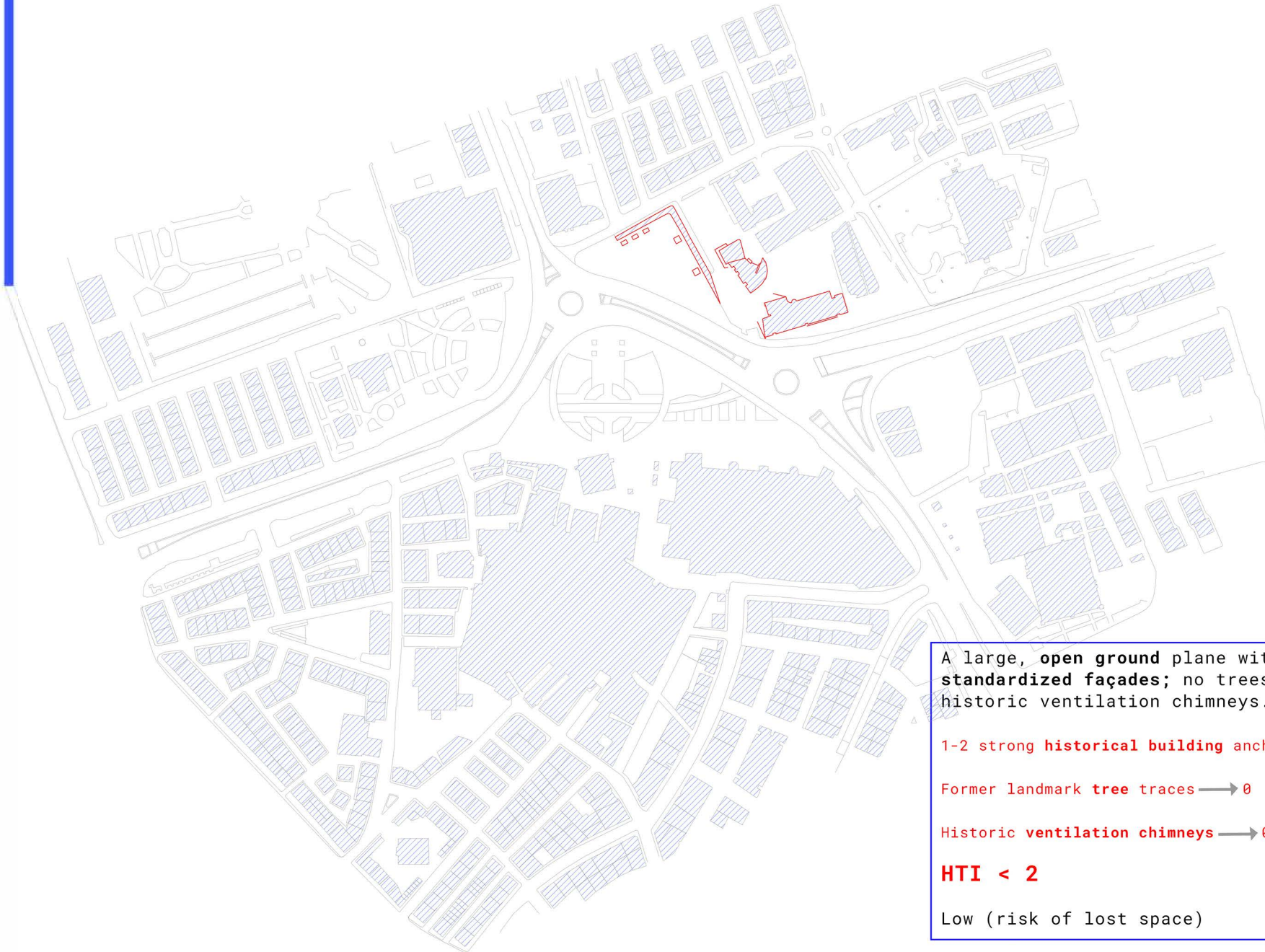

A large, **open ground** plane with **standardized façades**; no trees and no historic ventilation chimneys.

1-2 strong **historical building anchors** → +1

Former landmark **tree traces** → 0

Historic **ventilation chimneys** → 0

HTI < 2

Low (risk of lost space)

2.2C HUNAT MOSQUE - OK BURCU AXIS:

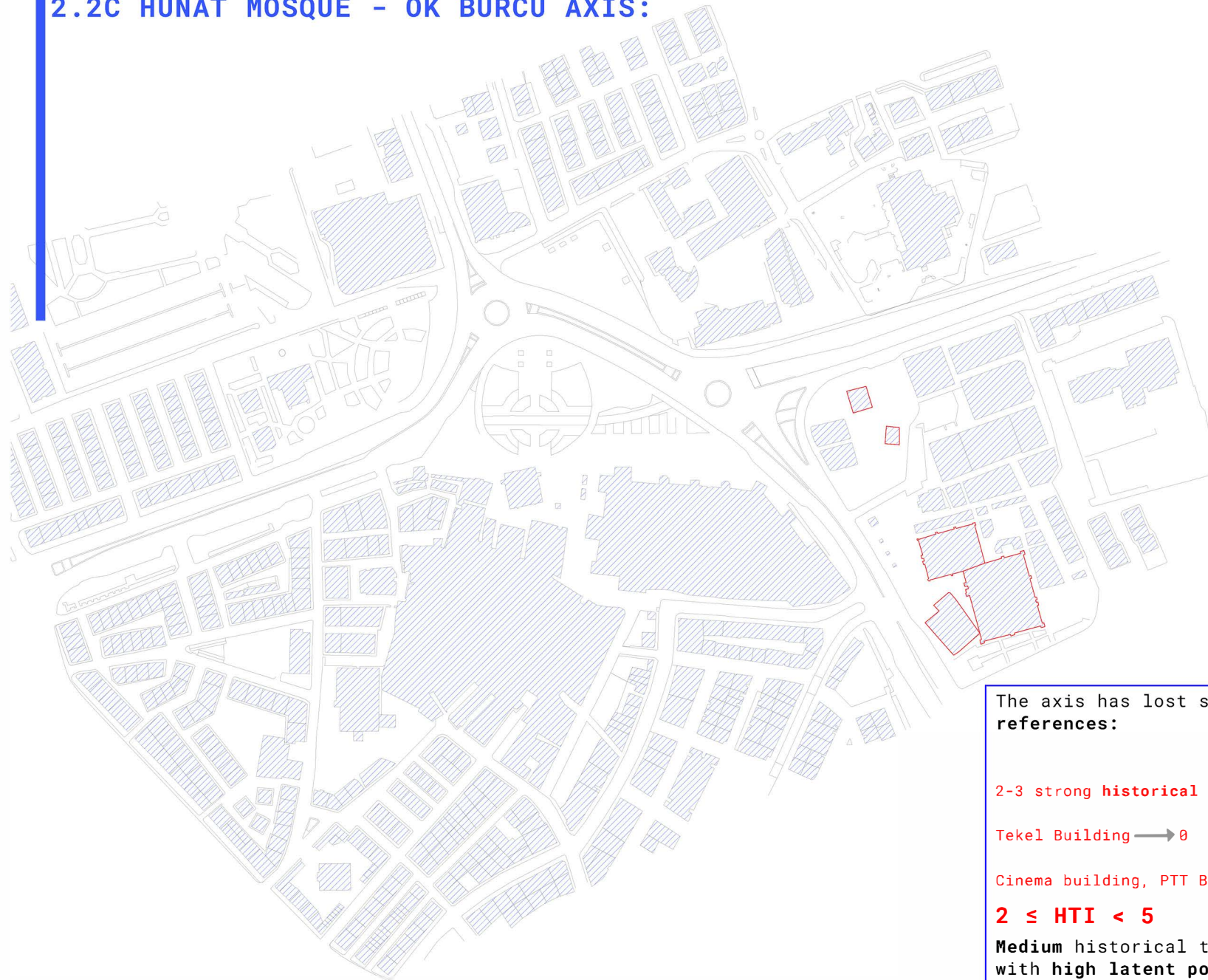

The axis has lost several key **historical references**:

2-3 strong **historical building anchors** → +4

Tekel Building → 0

Cinema building, PTT Building → 0

2 ≤ HTI < 5

Medium historical trace intensity, but with **high latent potential**.



CONTINUITY

- Kevin Lynch

3) PEDESTRIAN CONTINUITY AND INTERRUPTION RATIO:

Pedestrian Continuity and Interruption Ratio measures how many times a pedestrian can move from one end of the square to the other without interruption.

Interruptions include:

Waiting for the tram line or traffic signals

Crossing high-intensity vehicular roads

Detours caused by barriers, railings, or level differences

3.1 READING THRESHOLDS:

PCIR = Length of uninterrupted pedestrian route / Total distance that must be covered

0.8-1.0 → Very good (continuous flow, strong path)

0.5-0.8 → Medium (critical but still walkable)

< 0.5 → Poor (lost-space / anti-place perception)

1- Kayseri Tarihi Kalesi, 2-Hunat Hatun Külliyesi, 3- Fevziöglu İş Merkezi, 4- Tekel Binası,
5- PTT Binası, 6- Zeynel Abidin Türbesi, 7- Ok Burcu, 8- Alemdar Sineması ve Oteli,
9- Saat Kulesi, 10- İkinci Hükümet Konağı, 11- Tan Sineması, 12- Sahip Ata Medresesi,
13- Kurşunlu Cami, 14- İlk Atatürk Heykeli, 15- Kapalı Çarşı

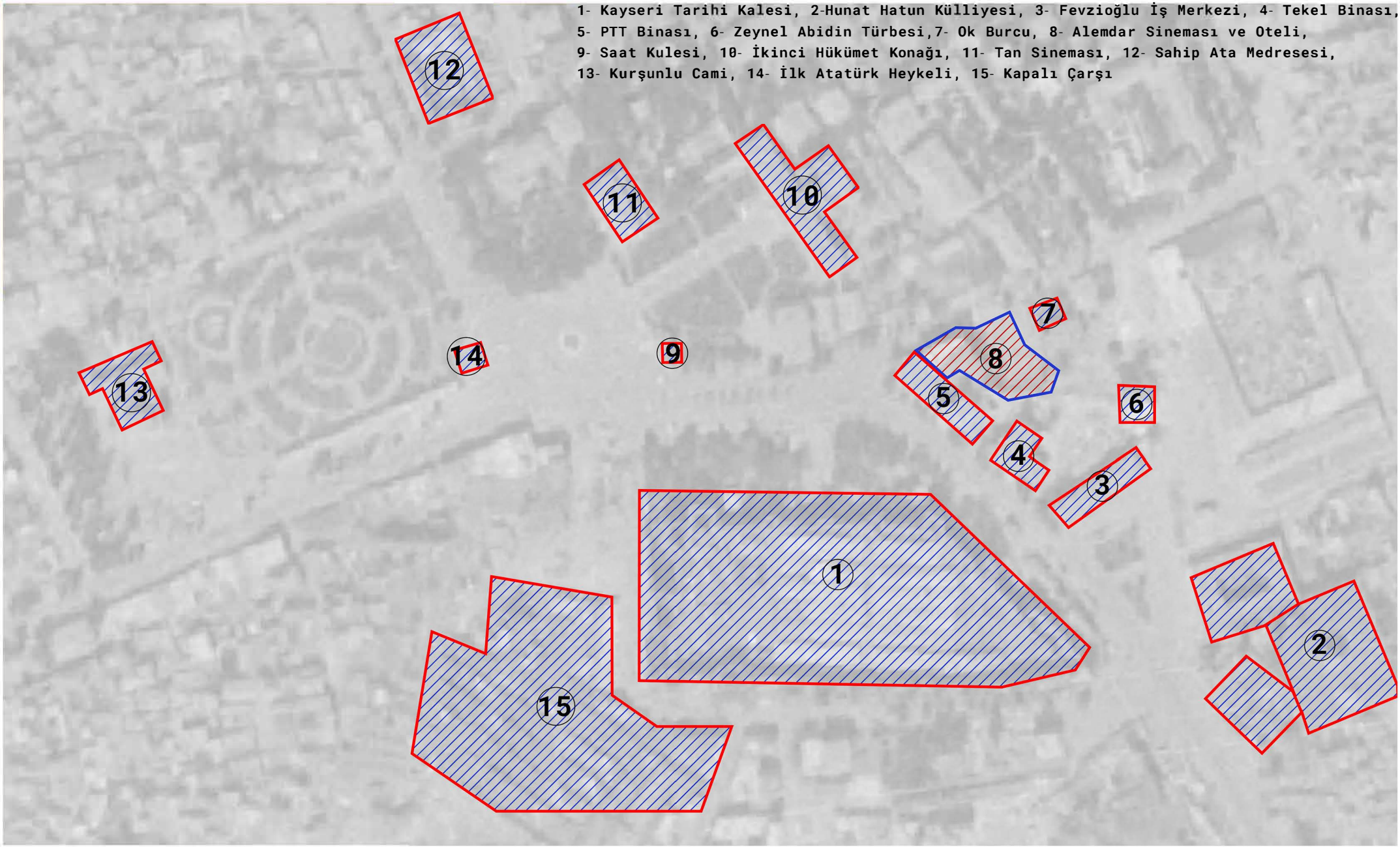

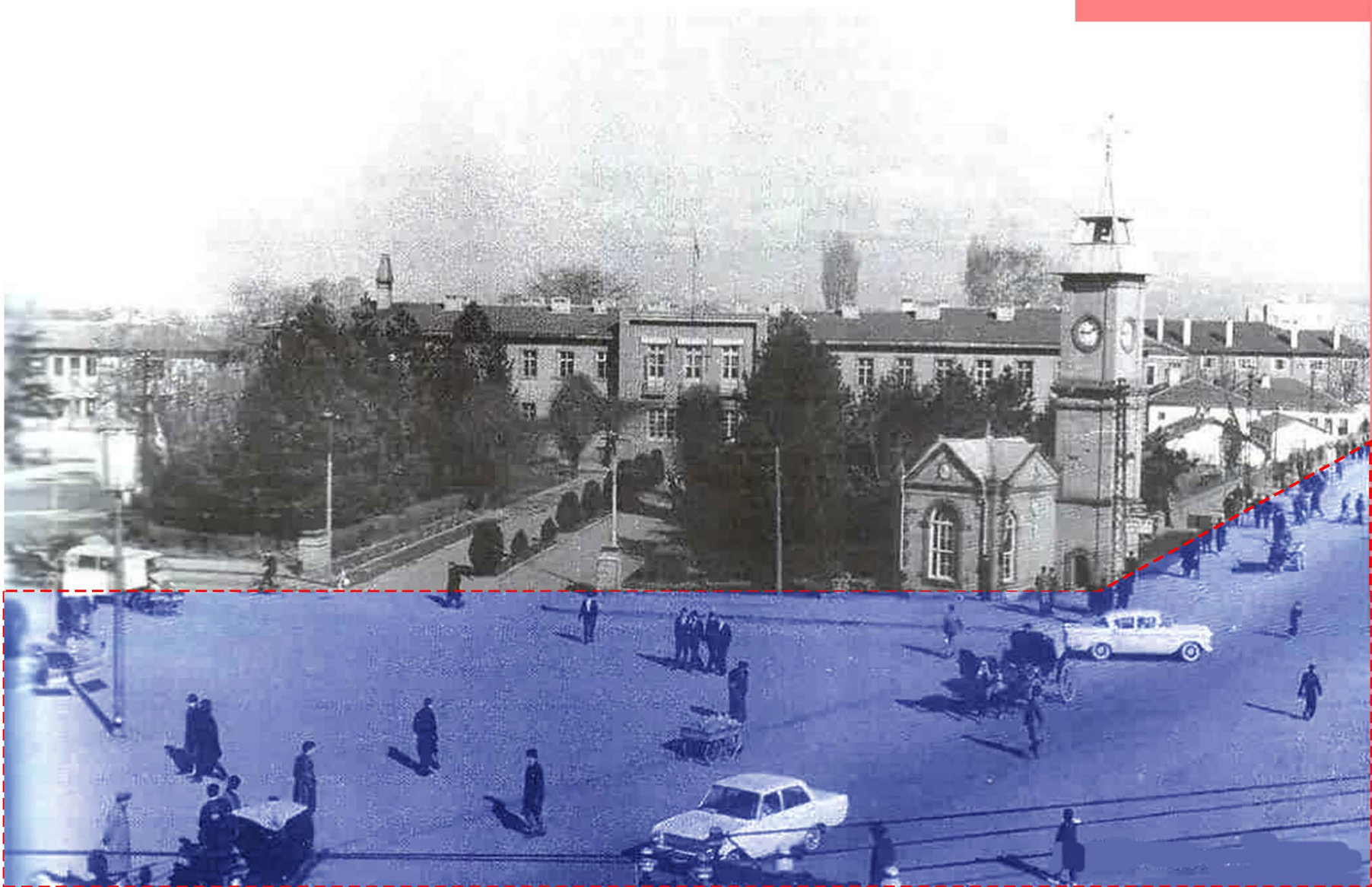





3.2A HUNAT MOSQUE - INNER CASTLE - KAPALIÇARŞI

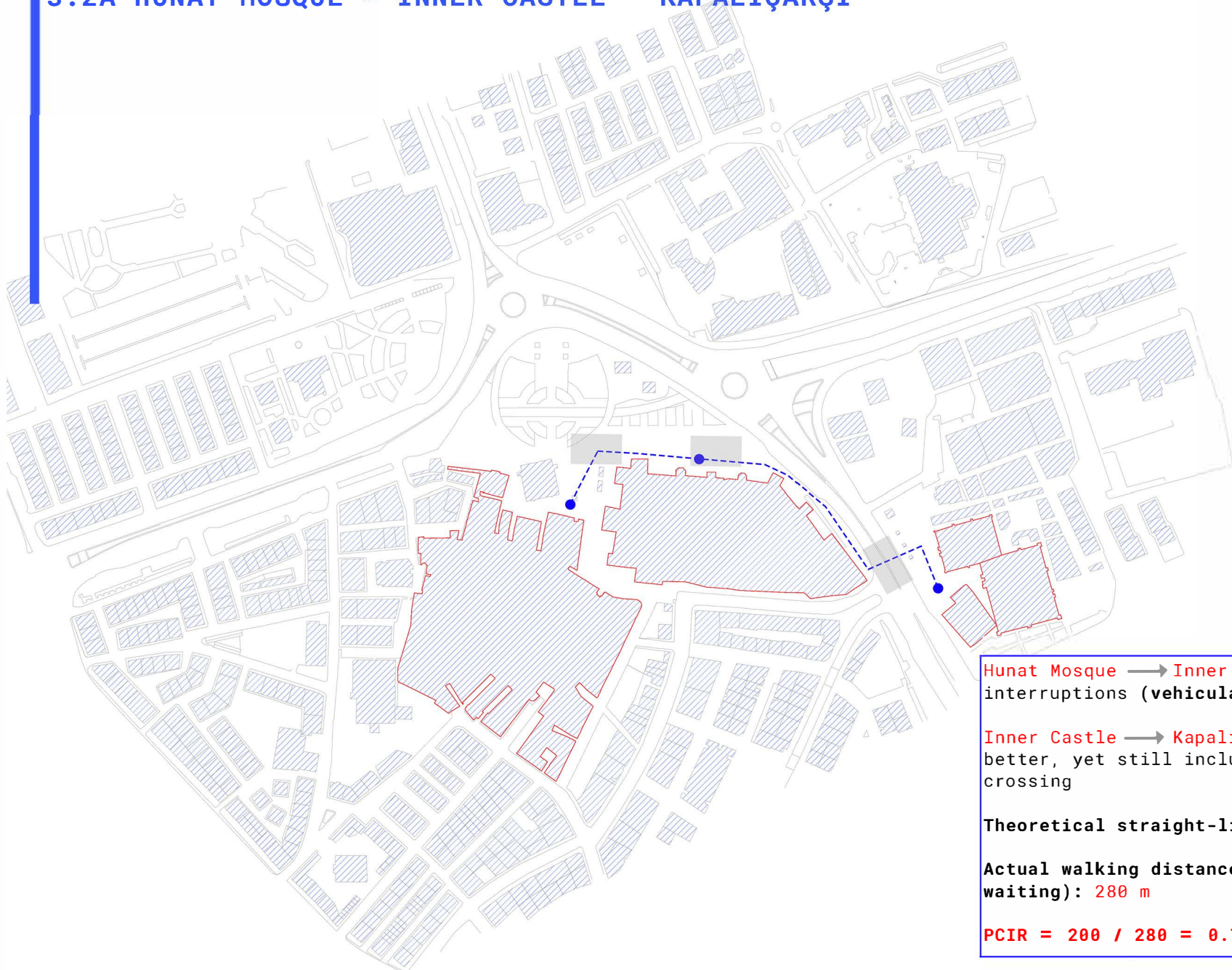

Hunat Mosque → Inner Castle: two interruptions (vehicular road + barriers)

Inner Castle → Kapalıçarşı: relatively better, yet still includes a road crossing

Theoretical straight-line distance: 200 m

Actual walking distance (detours + waiting): 280 m

PCIR = $200 / 280 = 0.7$ → CRITICAL

3.2B CEREMONIAL SQUARE – ATATÜRK MONUMENT – KAPALIÇARŞI

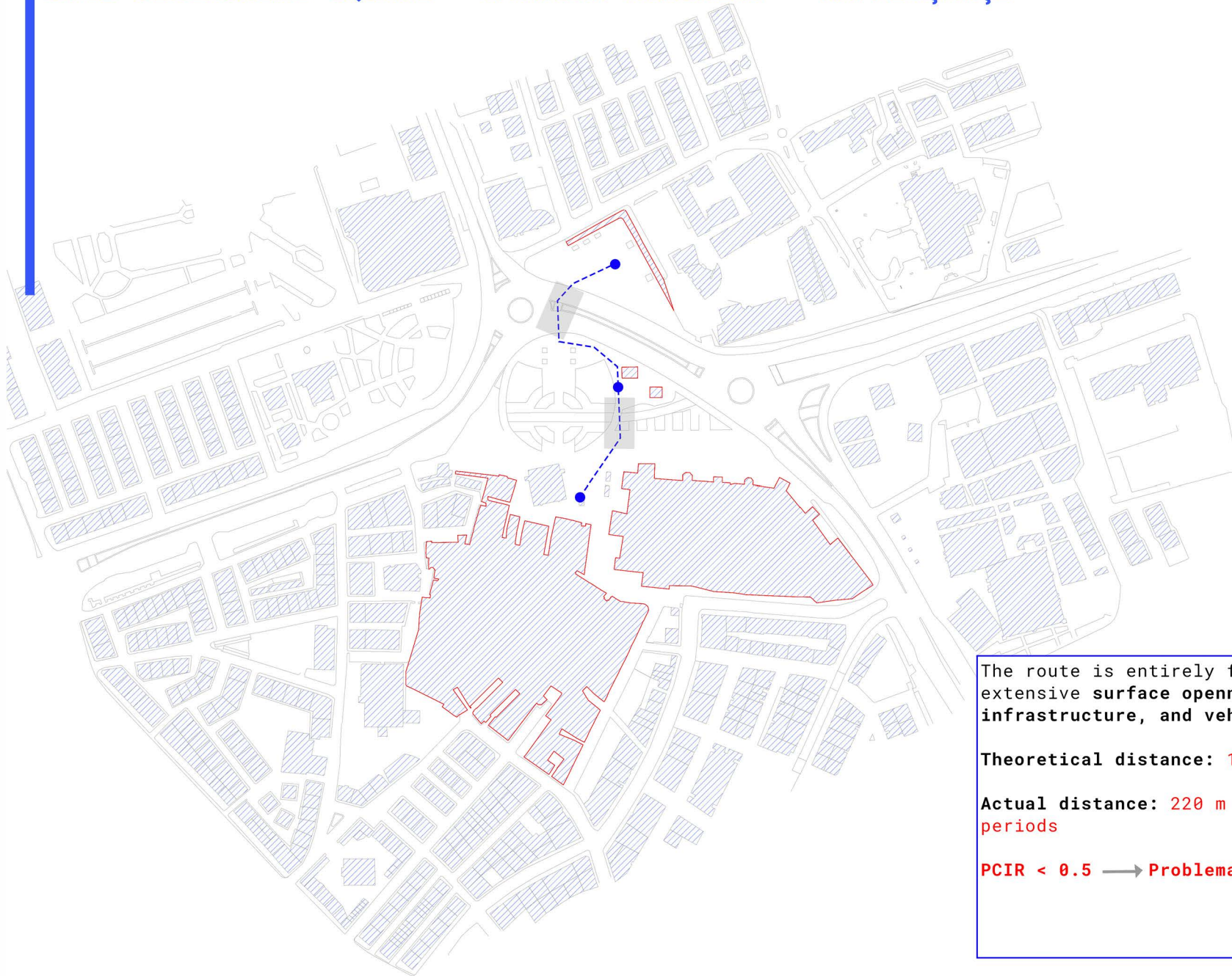

The route is entirely fragmented by extensive **surface openness**, **rail infrastructure**, and **vehicular roads**.

Theoretical distance: 120 m

Actual distance: 220 m + 1-2 waiting periods

PCIR < 0.5 → **Problematic**



PERMEABILITY

- Jane Jacobs

4) EDGE POROSITY COEFFICIENT:

The Edge Porosity Coefficient measures the number of **accessible openings (doors, passages, street entrances)** along an edge, divided by the total **edge length**.

4.1 READING THRESHOLDS:

EPC = Number of accessible entrances / Edge length (m)

EPC \geq 0.20 \longrightarrow one entrance every 5 m \longrightarrow **highly porous, lively frontage**

0.10 \leq EPC < 0.20 \longrightarrow **moderate porosity**

EPC < 0.10 \longrightarrow fewer than one entrance every 10 m \longrightarrow **blind façade / barrier effect**

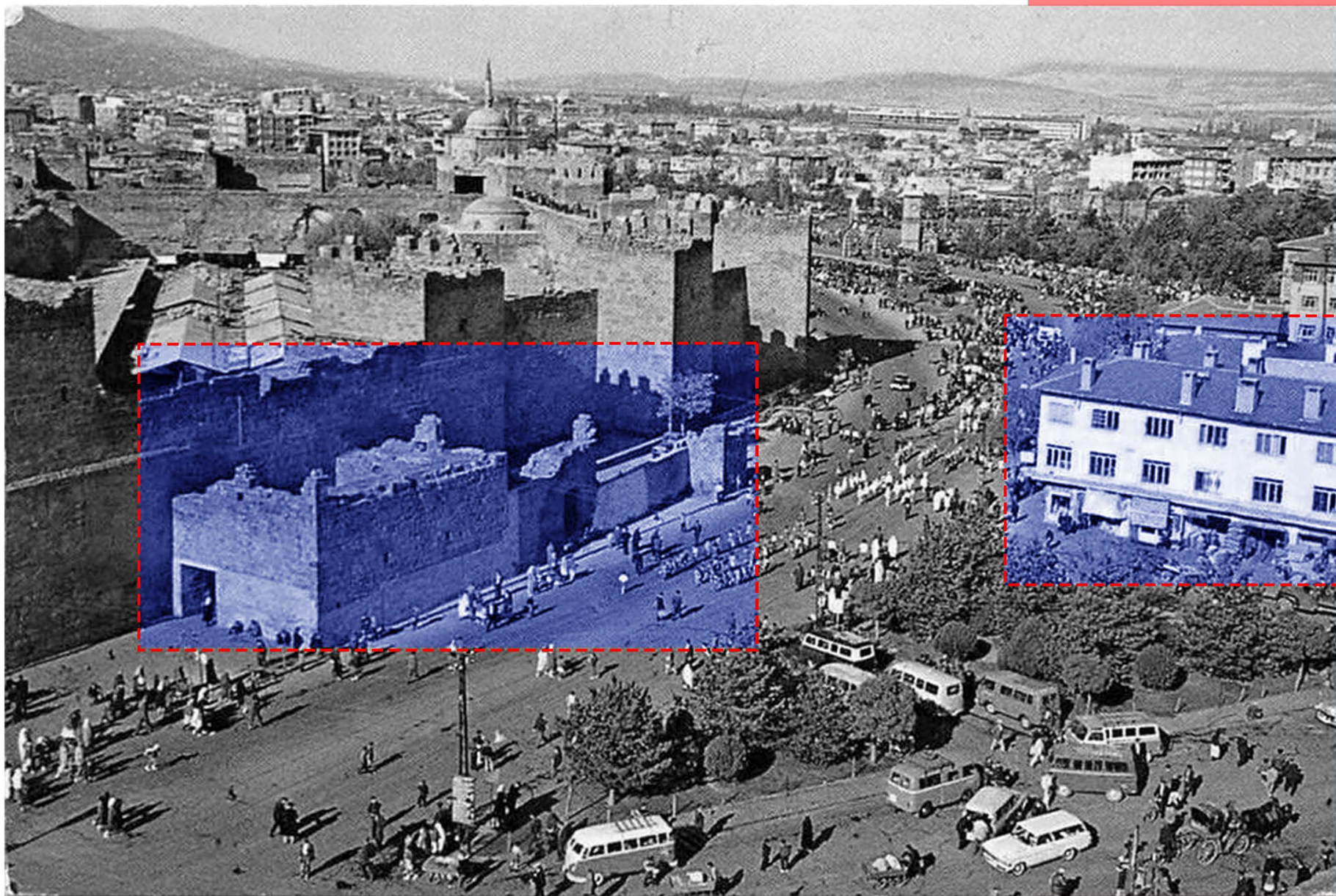

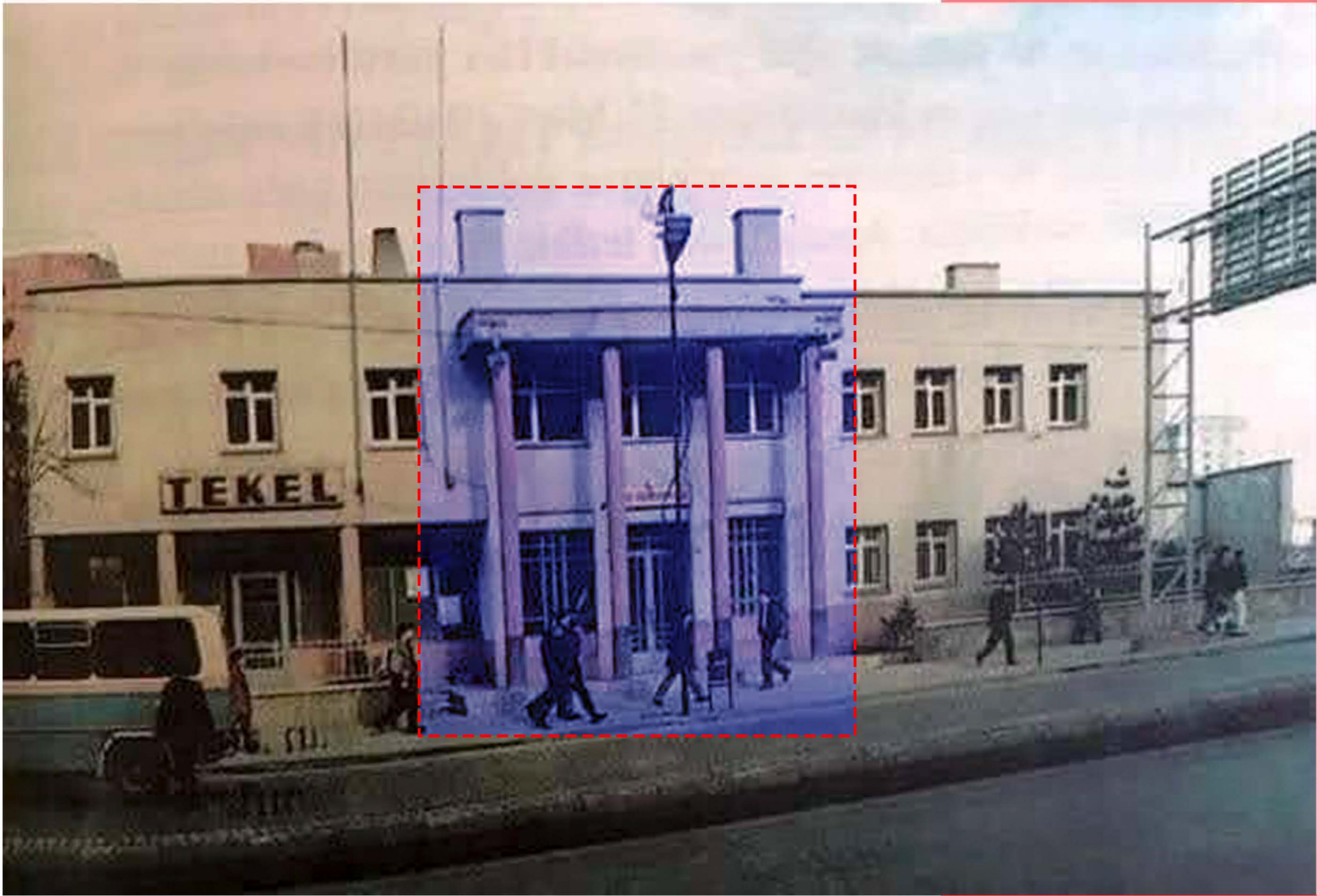



4.2A KAPALIÇARŞI FACADE - CASTLE WALLS - MUNICIPALITY BUILDINGS

Kapalıçarşı facade

Façade length = 60 m

Number of entrances / niches / side streets = 8

$$EPC = 8 / 60 \approx 0.13$$

→ Moderate-to-good porosity, permeable and inviting.

Castle walls

Length = 80 m

Actual entrances = 2-3 (main gate + secondary access)

$$EPC = 3 / 80 = 0.037$$

→ Very low porosity, strong barrier perception.

Municipality blocks (northern edge)

Length = 70-80 m

Entrances = 2-3 (main entrance + secondary accesses)

$$EPC = 0.03-0.05 \text{ range}$$

→ Although a public institution, the façade does not function as a public edge.



FUTURE

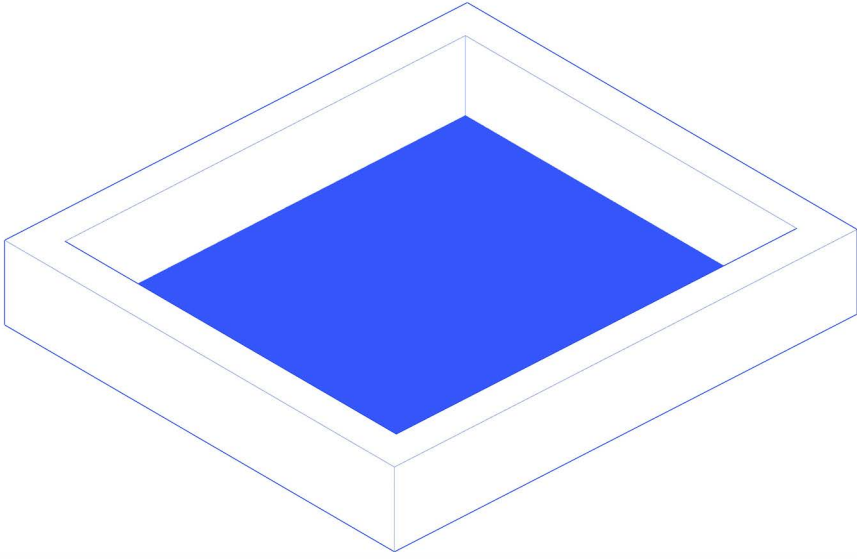

AVLU

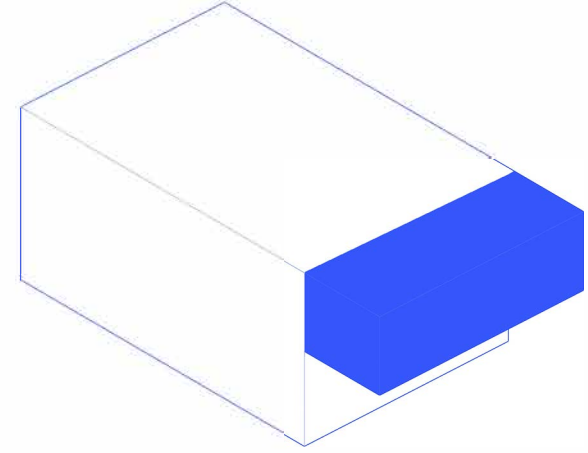

ÇIKMA

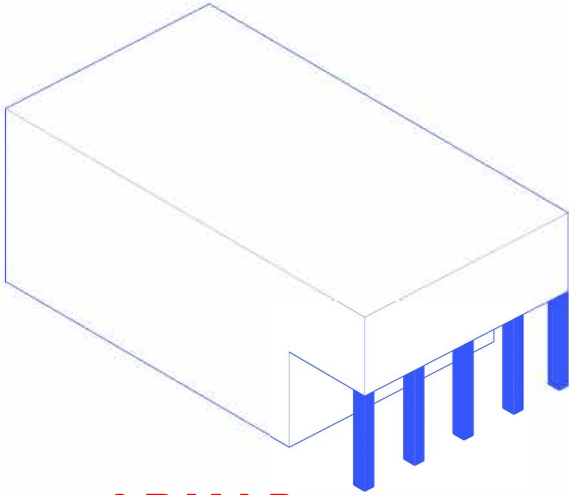

ARKAD

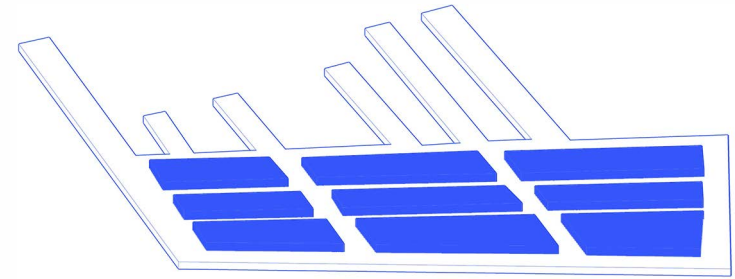

KAPALIÇARŞI

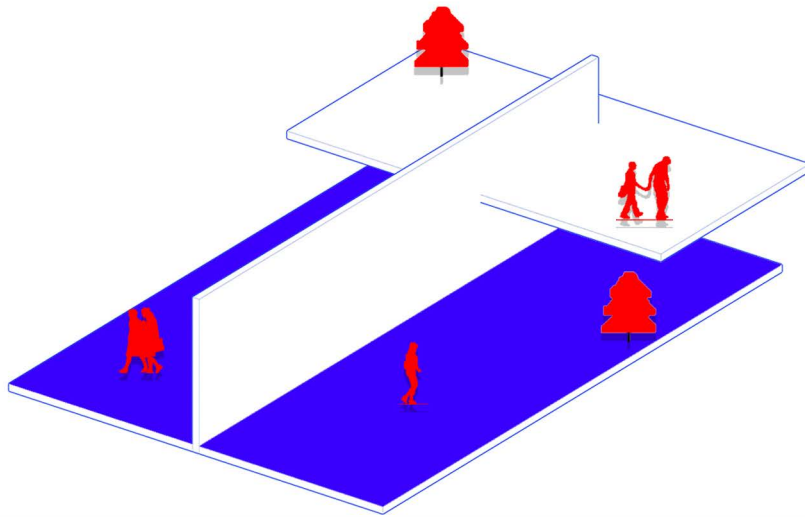

UNIQUE

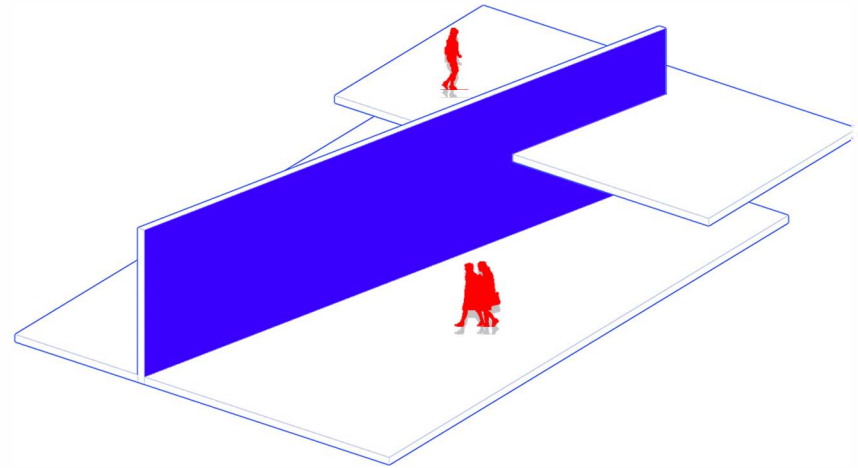

ROTATE

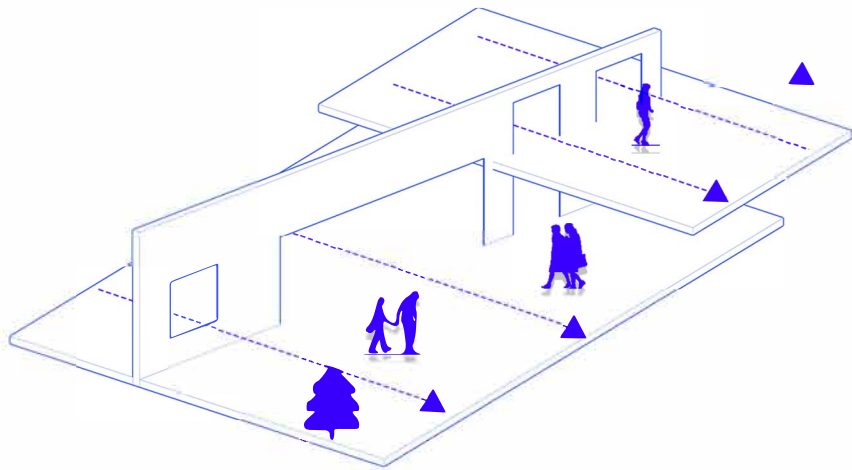

VOID

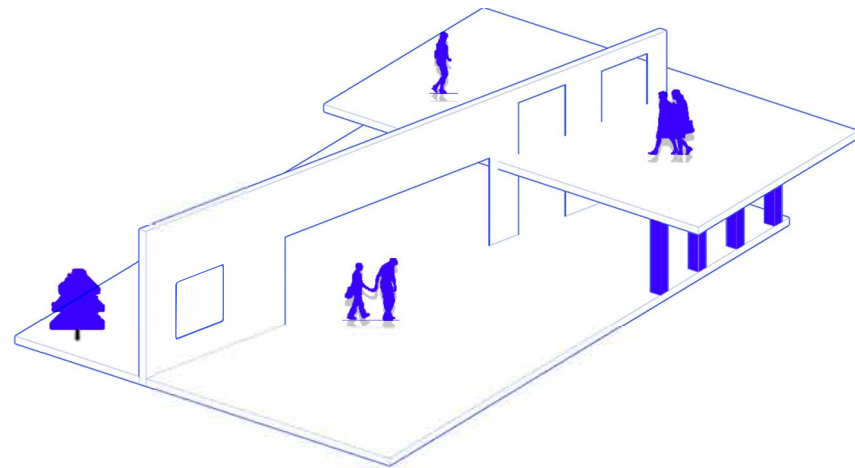

ELUNCTION

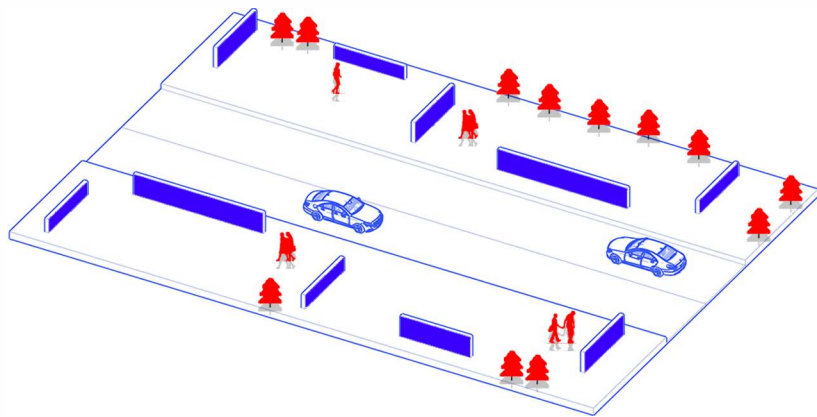

DYNAMIC

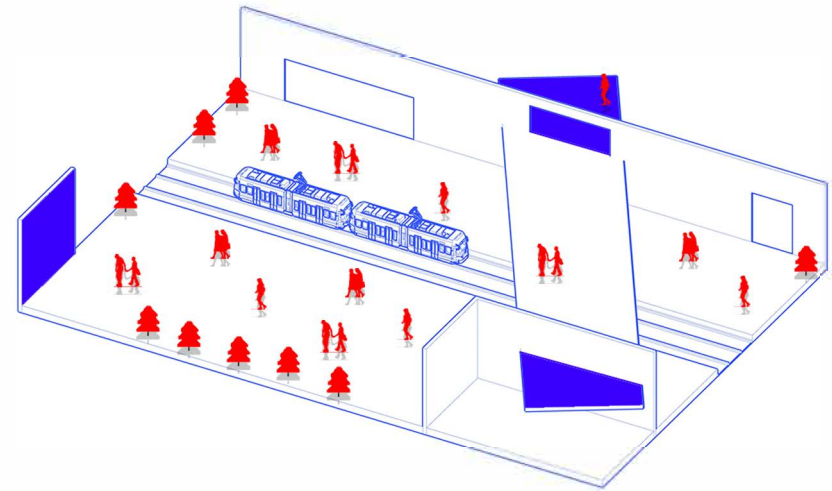

LINK

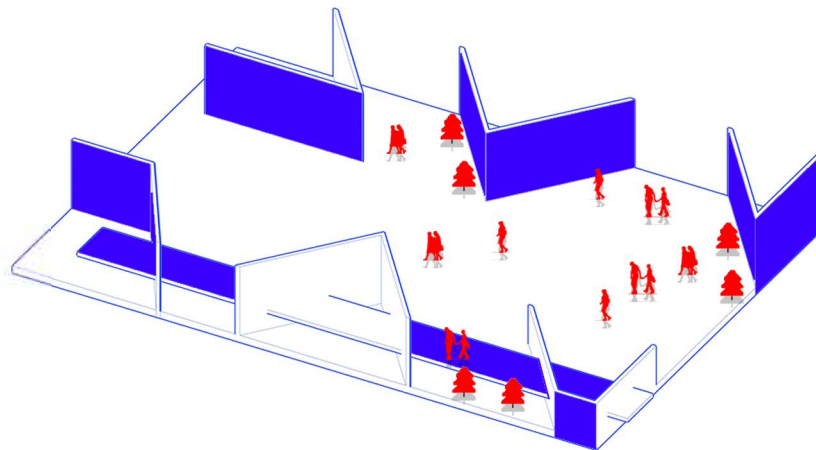

TRACE

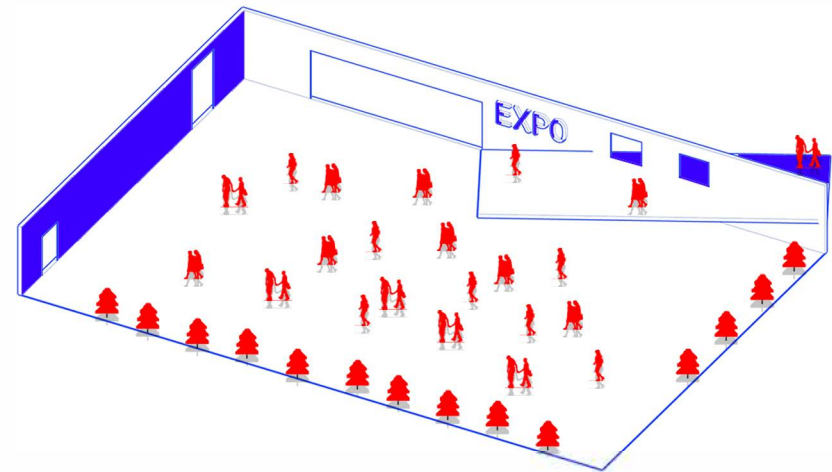

ACTIVITY

to be continued...